

Plat of Survey

Vintage on the Ponds

located in the Southwest 1/4 of Section 31, Town 3 North, Range 16 East, Town of Sugar Creek, and the Northwest 1/4 of Section 6, Town 2 North, Range 16 East, Town of Delavan, Walworth County, Wisconsin.

A strip of land off the entire North end of the Northeast 1/4 of the Northeast 1/4 of Section 6, Town 2 North, Range 16 East, Town of Delavan, County of Walworth and State of Wisconsin.

EXCEPTING THEREFROM All that portion thereof as is set forth in Certified Survey Map No. 3682 recorded in Volume 22 of Certified Surveys on Page 64 as Document No. 597277.

PARCEL 2:

A parcel of land located in the Southeast 1/4 of the Northwest 1/4 of Section 7, T2N, R16E, Town of Delavan, Walworth County, Wisconsin described as follows: Beginning at the Northwest corner of said SE 1/4; thence East to the NE corner of the Southeast 1/4 of the Northwest 1/4 of the Northwest 1/4 of Section 6, Town 2 North, Range 16 East, Town of Delavan, Wisconsin; thence South along the East line of the Northwest 1/4 of the Northwest 1/4 of the Northwest 1/4 of Section 6, Town 2 North, Range 16 East, Town of Delavan, Wisconsin; thence East to the NE corner of the Southeast 1/4 of the Northwest 1/4 of the Northwest 1/4 of Section 6, Town 2 North, Range 16 East, Town of Delavan, Wisconsin; thence South to the place of beginning.

PARCEL 3:

The East 1/2 of the Southwest 1/4 of Section 31, Town 3 North, Range 16 East, Town of Sugar Creek, Walworth County, Wisconsin.

EXCEPTING the parcel conveyed to William Seidell and Helen Seidell in deed recorded in Volume 336 of Deeds at page 475 as Document No. 379543 in the office of the Register of Deeds for Walworth County, Wisconsin.

AND FURTHER EXCEPTING THEREFROM A parcel of land located in the SW 1/4 of Sec. 31, T3N, R16E, Town of Sugar Creek, Walworth County, Wisconsin, described as follows: Commence at the Middle 1/4 corner of said Section 31; thence Southerly along the North and South 1/4 Section line 1406 feet, more or less; thence Westerly 327.3 feet, more or less; thence Northerly 227.7 feet, more or less; thence Westerly 200 feet, more or less, to the point of beginning; thence Southwesterly 200 feet, more or less; thence Northerly 165 feet, more or less; thence Westerly 630 feet, more or less; thence Southwesterly 260 feet, more or less; thence Southwesterly 200 feet, more or less; thence Northerly 150 feet, more or less; thence Northerly 145 feet, more or less; thence Easterly 600 feet, more or less; thence Northerly 140 feet, more or less; thence Easterly 796 feet, more or less, to the point of beginning.

AND FURTHER EXCEPTING THEREFROM A parcel of land located in the SW 1/4 of Section 31, T3N, R16E, Town of Sugar Creek, Walworth County, Wisconsin, described as follows: Commence at the Middle 1/4 corner of said Section 31; thence Southerly 1626 feet, more or less, to the point of beginning; thence continue on the said 1/4 line, Southerly 450 feet, more or less; thence Westerly 180 feet, more or less; thence Southwesterly 400 feet, more or less; thence Southwesterly 275 feet, more or less; thence Westerly 130 feet, more or less; thence Northerly 330 feet, more or less; thence Northerly 960 feet, more or less, to the point of beginning. (Note - This metes and bounds description falls entirely within Certified Survey Map No. 3682.)

All that portion thereof as is set forth in Certified Survey Map No. 3682 recorded in Volume 22 of Certified Surveys on Page 64 as Document No. 597277.

PARCEL 4:

The Northwest 1/4 of the Northeast 1/4 of the Northwest 1/4 of Section 6, Town 2 North, Range 16 East, Town of Delavan, Walworth County, Wisconsin.

PARCEL 5:

The South 1/2 of the Northeast 1/4 of the Northwest 1/4 of Section 6, Town 2 North, Range 16 East, Town of Delavan, Walworth County, Wisconsin.

PARCEL 6:

All that part of the West 1/2 of the Northwest 1/4 of Section 6, T2N, R16E, Town of Delavan, Walworth County, Wisconsin, that lies North of Turtle Creek and being 4 rods wide on the West end and 28 rods wide on the East end, EXCEPTING THEREFROM All that portion thereof as is set forth in Certified Survey Map No. 3699 recorded in Volume 22 of Certified Surveys on Page 114 as Document No. 605112.

PARCEL 7:

The Southwest 1/4 of the Southwest 1/4 of Section 31, T3N, R16E, Town of Sugar Creek, Walworth County, Wisconsin.

EXCEPTING THEREFROM the following described parcel to-wit: Beginning at the NW corner of said Southwest 1/4 of the Southwest 1/4, thence East along the North line thereof 40 rods, thence South 70 rods, thence West 40 rods, thence North 70 rods, along the West side thereof to the place of beginning.

AND FURTHER EXCEPTING THEREFROM land described in deed recorded in Volume 405 of Deeds on page 77, Document No. 485417, in the office of the Register of Deeds for Walworth County, Wisconsin.

AND FURTHER EXCEPTING THEREFROM A parcel of land located in the SW 1/4 of Sec. 31, T3N, R16E, Walworth County, Wisconsin, described as follows: Commence at the Middle 1/4 corner of said Section 31; thence Southerly along the North and South 1/4 Section line 1406 feet, more or less; thence Westerly 327.3 feet, more or less; thence Northerly 227.7 feet, more or less; thence Westerly 200 feet, more or less, to the point of beginning; thence Southwesterly 200 feet, more or less; thence Northerly 165 feet, more or less; thence Westerly 630 feet, more or less; thence Southwesterly 260 feet, more or less; thence Southwesterly 200 feet, more or less; thence Northerly 150 feet, more or less; thence Northerly 145 feet, more or less; thence Easterly 600 feet, more or less; thence Northerly 140 feet, more or less; thence Easterly 796 feet, more or less, to the point of beginning.

PARCEL 8:

A parcel of land located in the NW 1/4 of Section 6, T2N, R16E, Town of Delavan, Walworth County, Wisconsin more fully described as: Beginning at the Southeast corner of the NE 1/4 of the NE 1/4 of the NW 1/4 of Section 6, T2N, R16E, Walworth County, Wisconsin, thence North to a point on the South line of what is generally referred to as the Moore property, thence Southwesterly to the point of beginning, meaning and intending to include the Southwesterly 1/2 of the 5 1/2 acres of land, more or less, formerly owned by Benjamin Filcroft.

PARCEL 9:

A parcel of land located in the SW 1/4 of Sec. 31, T3N, R16E, Town of Sugar Creek, Walworth County, Wisconsin, described as follows: Commence at the Middle 1/4 corner of said Section 31; thence Southerly along the North and South 1/4 Section line 1406 feet, more or less; thence Westerly 327.3 feet, more or less; thence Northerly 227.7 feet, more or less; thence Westerly 200 feet, more or less, to the point of beginning; thence Southwesterly 200 feet, more or less; thence Northerly 165 feet, more or less; thence Westerly 630 feet, more or less; thence Southwesterly 260 feet, more or less; thence Southwesterly 200 feet, more or less; thence Northerly 150 feet, more or less; thence Northerly 145 feet, more or less; thence Easterly 600 feet, more or less; thence Northerly 140 feet, more or less; thence Easterly 796 feet, more or less, to the point of beginning.

PARCEL 10:

A parcel of land located in the SW 1/4 of Section 31, T3N, R16E, Town of Sugar Creek, Walworth County, Wisconsin, described as follows: Commence at the Middle 1/4 corner of said Section 31; thence Southerly 1626 feet, more or less, to the point of beginning; thence continue on the said 1/4 line, Southerly 450 feet, more or less; thence Westerly 180 feet, more or less; thence Southwesterly 400 feet, more or less; thence Southwesterly 275 feet, more or less; thence Westerly 130 feet, more or less; thence Northerly 330 feet, more or less; thence Northerly 960 feet, more or less, to the point of beginning. (Note - This metes and bounds description falls entirely within Certified Survey Map No. 3682.)

EXCEPTING THEREFROM All that portion thereof as is set forth in Certified Survey Map No. 3682 recorded in Volume 22 of Certified Surveys on Page 64 as Document No. 597277.

PARCEL 11:

Lots 1 and 2 of Certified Survey Map No. 3682 recorded in Volume 22 of Certified Surveys on Page 64 as Document No. 597277, and being part of the Southeast 1/4 of the Southwest 1/4 of Section 31, T3N, R16E, Town of Sugar Creek and the Northeast 1/4 of the Northwest 1/4 of Section 6, T2N, R16E, Town of Delavan, Walworth County, Wisconsin.

Tax Key Numbers: F D 600005, F D 600009A, F D 600010, G SC310006A, G SC310007, G SC310009, GA36820001, GA36820002 and FA36820002.

Note A:

Visited site June 23, 2015 and located an iron rod at the Southwest corner of Tax Parcel GSC 3100007A as shown on a survey by David F. Abell dated June 15, 1988, which had been moved to the NW corner of the Southwest 1/4 of the Northwest 1/4 of the Northwest 1/4 of Section 31, T3N, R16E, Town of Sugar Creek, Walworth County, Wisconsin, on or about October 22, 1985. Set iron pipe at the intersection of the South line of the Southwest 1/4 of the Northwest 1/4 of the Northwest 1/4 of Section 31, T3N, R16E, Town of Sugar Creek, Walworth County, Wisconsin, and the East line of the Southwest 1/4 of the Northwest 1/4 of the Northwest 1/4 of Section 31, T3N, R16E, Town of Sugar Creek, Walworth County, Wisconsin, as shown on Abell's survey.

"Parcel 9"
Tax Parcel
GSC 3100009

"Parcel 3"
Tax Parcel
GSC 3100007

"Parcel 7"
Tax Parcel
GSC 3100006A

"Parcel 6"
Tax Parcel
FD 600005

"Parcel 4"

"Parcel 11"
Lot 2
Tax Parcel
FA368200002

"Parcel 8"
Tax Parcel
FD 600009A

Tax Parcel
FD 600010

"Parcel 5"

"Parcel 2"



Copyright 2015 by Olson Land Surveying, LLC.

All rights reserved. No part of this survey plat may be reproduced or transmitted in any form by any means - graphic, electronic, or mechanical, including photocopying, tracing, or information storage and retrieval systems - without permission in writing from Douglas G. Olson, Olson Land Surveying, LLC.

I hereby certify that I have surveyed the above described property and the map hereon is correct to the best of my professional knowledge and belief and shows the size and location of the property, its exterior boundaries, the location and dimensions of all visible structures thereon, boundary fences, apparent easements and roadways and visible encroachments, if any.

This survey is made for the exclusive use of the present owners of the property, and also those who purchase, mortgage or guarantee title thereto, within one year from the date hereof.

Douglas G. Olson
Wisconsin Professional Land Surveyor - 2093

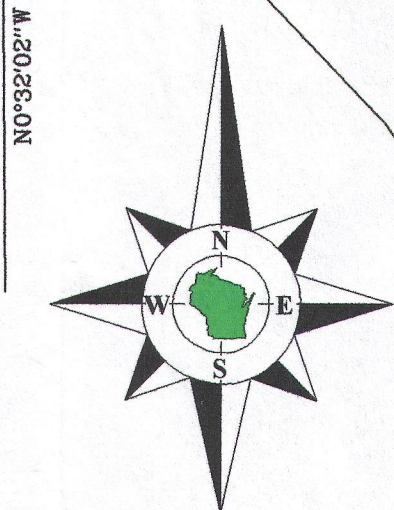

Bearings reference to the Wisconsin State Plane Coordinate System, South Zone.

Surveyed for: Vintage on the Ponds
4901 Dam Road
Delavan, Wisconsin. 53115

Note:
The location of Turtle Creek and various ponds and creeks have been imported from the Walworth County digital mapping and have not been field verified.

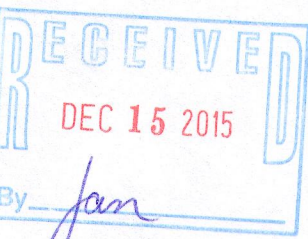

Scale in Feet
1" = 120'

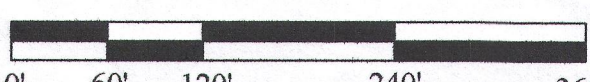

Survey date: June 4, 2015.

Revisions: No. 1 - See Detail A and Note A.

GA3682-1 FA3682-2
GA3682-2 Fd 6-10
G 2C 31-9 Fd 6-5
G 2C 31-7 Fd 6-9A
G 2C 31-4A Fd 6-9

Sheet 1 of 2 Sheets

Drawing Name:

Job Reference Number

2015.019

Legend

- Found County Section Corner
- Found Iron Pipe
- Found Iron Rod
- Recorded Information
- Utility Pedestal
- Manhole or Concrete Cover
- Septic Vent or PVC Cap
- Wood Gate Post
- Asphalt Surface
- Concrete Surface
- Gravel Surface
- Filler

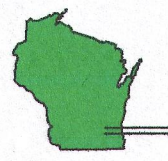

Olson Land Surveying, LLC

45 South Wisconsin Street * P.O. Box 322 * Elkhorn, Wisconsin. 53121

Telephone: (262) 723-3434 * Facsimile: (262) 723-8044

Email: doug@olsonsurveying.com

Plat of Survey

of Vintage on the Ponds

located in the Southwest 1/4 of Section 31, Town 3 North, Range 16 East, Town of Sugar Creek, and the Northwest 1/4 of Section 6, Town 2 North, Range 16 East, Town of Delavan, Walworth County, Wisconsin.

Surveyed for: **Vintage on the Ponds**
N4901 Dam Road
Delavan, Wisconsin. 53115

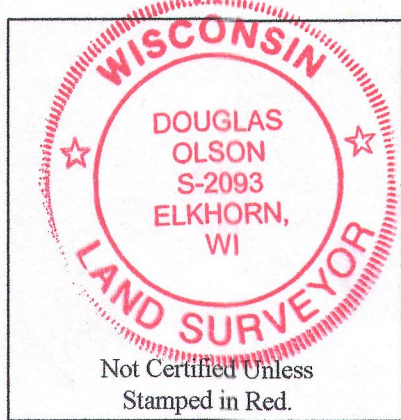
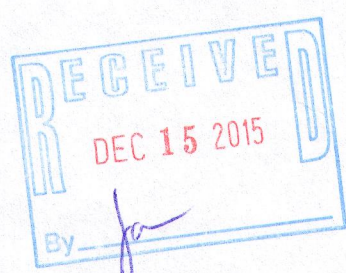

Notes:

- 1) This survey plat is not certified unless signed and sealed in red ink.
- 2) This survey is subject to Wisconsin lien laws. This Plat of Survey is the notice of intent to file lien. Lien waiver required.

Copyright 2014 by Jensen & Olson Land Surveying, LLC.

All rights reserved. No part of this survey plat may be reproduced or transmitted in any form by any means - graphic, electronic, or mechanical, including photocopying, tracing, or information storage and retrieval systems - without permission in writing from Douglas G. Olson, Jensen & Olson Land Surveying, LLC.

I hereby certify that I have surveyed the above described property and the map hereon is correct to the best of my professional knowledge and belief and shows the size and location of the property, its exterior boundaries, the location and dimensions of all visible structures thereon, boundary fences, apparent easements and roadways and visible encroachments, if any.

This survey is made for the exclusive use of the present owners of the property, and also those who purchase, mortgage or guarantee title thereto, within one year from the date hereof.

Douglas G. Olson
Wisconsin Registered Land Surveyor - 2093



Bearings reference to the Wisconsin State Plane Coordinate System, South Zone.

See Sheet 1

"Parcel 3"
Tax Parcel
GSC 3100007

"Parcel 11"
Lot 1
Tax Parcel
GA368200001

7.177 Acres
312,646 Sq.Ft.
6.632 Acres
288,887 Sq.Ft.
Exclusive of R.O.W.

Pond

Location imported from the Walworth County digital mapping and not field verified.

See Sheet 1

"Parcel 3"
Tax Parcel
GSC 3100007

Pond

Location imported from the Walworth County digital mapping and not field verified.

"Parcel 4"
Tax Parcel
FD 600010

See Sheet 1

"Parcel 8"
Tax Parcel
FD 600009A



Olson Land Surveying, LLC

45 South Wisconsin Street * P.O. Box 322 * Elkhorn, Wisconsin. 53121
Telephone: (262) 723-3434 * Facsimile: (262) 723-8044
Email: doug@olsonsurveying.com

Scale in Feet

1" = 40'

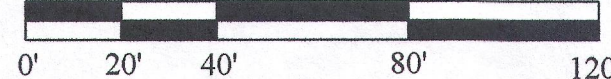

Survey date: July 10, 2014.

Revisions: No. 1 - Misc. notations
No. 2 - Now 2015019
Sheet 2 of 2

Sheet 2 of 2 Sheets

Drawing Name:

Job Reference Number

2015.019

Legend

- Found County Section Corner
- Found Iron Pipe
- Found Iron Rod
- Recorded Information
- Utility Pedestal
- Manhole or Concrete Cover
- Septic Vent or PVC Cap
- Wood Gate Post
- Asphalt Surface
- Concrete Surface
- Gravel Surface
- Set Iron Pipe, 1" dia.
- Utility Pole
- Pillar